

# ACCESS TO LABS IN F2021

(LASTS UNTIL FURTHER NOTICE – SLIDES UPDATED THE 13<sup>TH</sup> OF APRIL 2021)



AARHUS  
UNIVERSITY  
DEPARTMENT OF COMPUTER SCIENCE

LAB OPENING F2021  
1 FEBRUARY 2021

SIMON MØLLER CHRISTENSEN  
LAB COORDINATOR



KEEP YOURSELF UPDATED AT:

[CS.AU.DK/LAB](https://cs.au.dk/lab)

AND

[HTTPS://MEDARBEJDERE.AU.](https://medarbejdere.au.dk/corona/til-studerende/)

[DK/CORONA/TIL-](https://medarbejdere.au.dk/corona/til-studerende/)

[STUDERENDE/](https://medarbejdere.au.dk/corona/til-studerende/)

# CORONA RULES

---

Labs are open to students, who require lab work in the following courses:

- itPDP
- Innovation Project
- Shape-changing Objects and Spaces
- MSc-projects and Bachelor projects

You must adhere to the following rules:

- A mask/visor must be worn when moving around, but can be removed when seated at a station.
- When in lab you must have had a test less than 72 hours, of course with a negative result.
- Use sanitizer and wash hands regularly. Sanitize used surfaces and equipment. Don't sanitize fragile machinery and computers.
- Social distancing of at least 1 meter is required. Maximum room occupancy is to be respected.

# LAB RULES

---

Stibitz3 is strictly for students in the “Innovation Project” course.

“Innovation Project” need to book a workstation time slot, outside of allocated time for lab/practical exercises.

Chomsky is strictly for students in the “ITPDP” course.

“ITPDP” need to book a workstation time slot, outside of allocated time for lab/practical exercises.

You are only allowed in the lab to do lab work. Preparation for laser cutting is acceptable at a workstation. Report writing is not.

You have card access, but do not enter without booking a time.

The labs will be supervised but not full-time manned. Occasional controls of negative CoViD-tests should be expected.

You cannot pre-book equipment. The lab is “walk-up-and-use” when booking a workspace.

Waiting time and queueing is to be expected.

**Failure to comply with rules will result in having lab access privileges revoked.**



# LAB OVERVIEW

---

## **7 workstations (5 in Stibitz1, 2 in Stibitz2):**

Prep. work for 3D printing, laser cutting etc. or for assembling, soldering, tinkering.

## **3D Printers in Stibitz2:**

8 PRUSA Minis. Walk up and use. Leave post-it note with contact info.

## **FORMLab:**

Handtools, machinery. Do not use the CNC yet – ask labtools for CNC-help.

## **PROTOlab:**

Laser cutting and PCB prioritized. PRUSA Mk2.5s and Creality CR10S5 walk-up-and-use.

**STIBITZ 3  
STRICTLY  
FOR  
INNOVATION  
PROJECT  
STUDENTS**

**MAXIMUM OCCUPANCY  
(present in/near station)**

**FORMLab: 2**

**PROTOlab: 2**

**3D Printers: 3**

**A WORKSPACE:  
3 individuals per station.**

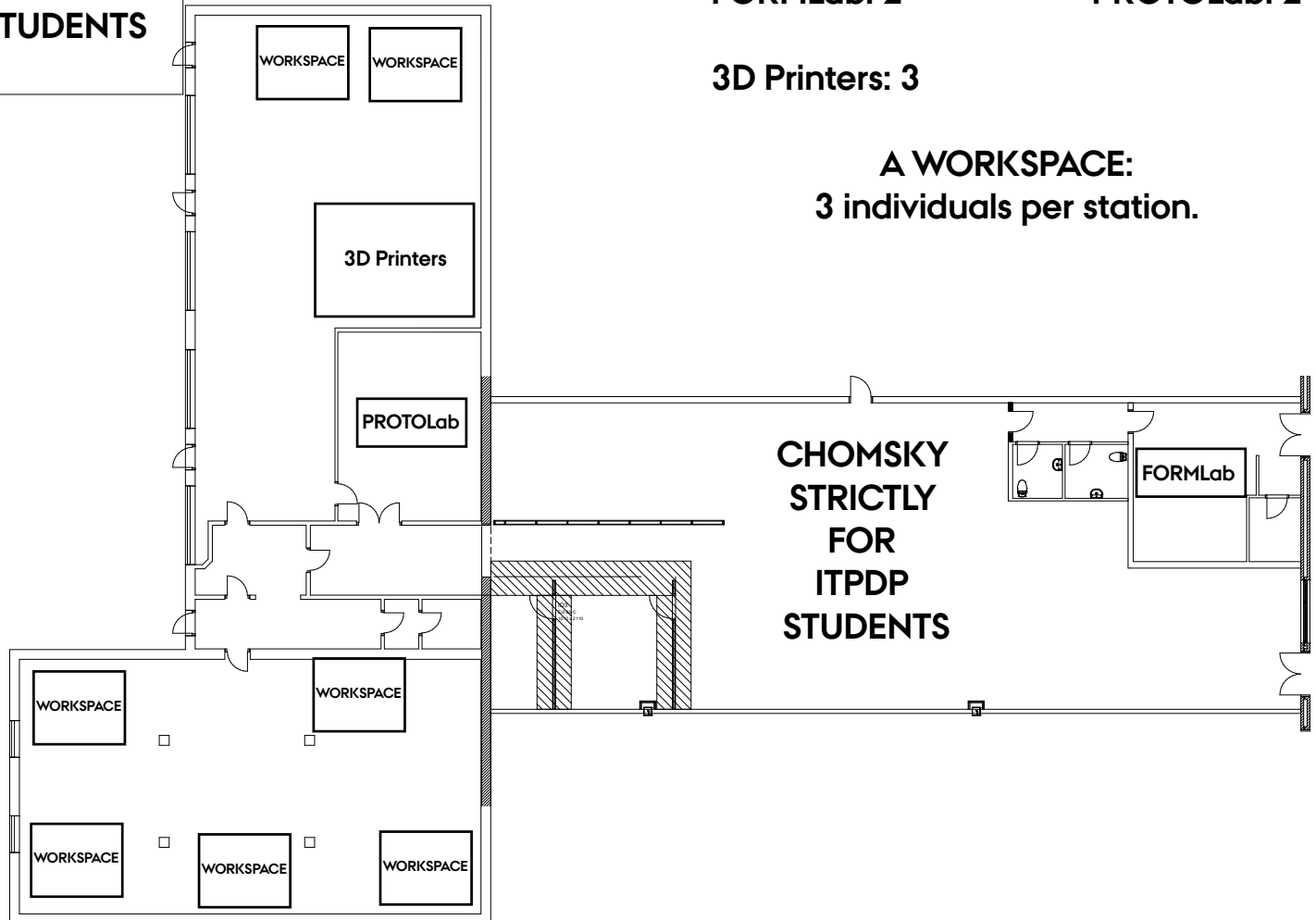

# PROCEDURE: NEGATIVE TEST

---

A negative test no older than 72 hours is required when working in lab.

The 72 hours is from when the test was taken, not when you got the result.

There will be control and sporadic checks of negative CoViD-tests.

Failure to comply with showing negative test will result in being expelled from campus.

Employees will be in charge of sporadic controls. Control of tests is an executive decision.

Unacceptable behavior towards employees doing mandatory tasks will not be accepted.

# PROCEDURE: SANITIZING

---

**Sanitize hands before and after working with equipment, machinery and when entering/exiting your workstation.**

**3D printers: Sanitize hands or use gloves. Do not sanitize display or buttons/switches.**

**Laser cutter: Sanitize hands or use gloves. Do not sanitize computer, keyboard or mouse.  
Sanitize handle and lid of laser cutter.**

**PCB and Foam Cutter: Use gloves.**

**FORMLab. Sanitize hands prior to working in FORMLab. Sanitize all hand tools. Sanitize mechanical machinery, i.e sanitize handle on column-drill, but don't sanitize Dremels.**



# PROCEDURE: SAFETY

---

Do not use the CNC by yourself - contact [labtools@cs.au.dk](mailto:labtools@cs.au.dk) if you want to use it.

**3D printers:** You are allowed to leave prints overnight. Make sure to book a timeslot to pick up your print, and do not show up without a booking.

**Laser cutter:** Laser cuts cannot be left overnight or by itself. You should be present at all times when laser cutting.

Make sure to get familiar with fire extinguisher and first aid kit locations.

Call Simon at +45 28 94 34 12 in case of “lab emergencies”.

Call 112 in case of actual emergencies 😊

# HOW TO BOOK A WORKSPACE TIMESLOT

---

Two timeslots (9-13 and 13-17) until end of semester.  
Weekends are now included.

Booking:

<https://tinyurl.com/CSLabF2021Q2>



AARHUS  
UNIVERSITY